



Approvals

Registered Owners

Address of Body Corporate
96 - 100 Pukuatua Street, Rotorua

Memorandum of Easements in Gross

Purpose	Serv. Ten.	Shown	Grantee
Right to Drain Sewage	Lot 1 hereon	(A) (A2)	Rotorua District Council
	Lot 2 hereon	(B) (B2)	

Schedule of Proposed Easements

Purpose	Serv. Ten.	Shown	Dom. Ten.
Right to Convey Geothermal Steam	Lot 2 hereon	(C) (B2)	Sec. 16 SO13178
	Lot 2 hereon	(C) (B2) (B)	Lot 1 hereon
	Lot 1 hereon	(D) (A2)	Lot 2 hereon

AREAS AND MEASUREMENTS ARE
SUBJECT TO SURVEY.REDUCED COPY
NOT ORIGINAL SCALETotal Area ... 3035m²

Comprised in CT 18A/197

I, BART YETSENGA

Registered Surveyor and holder of an annual practising certificate (or who may act as a registered surveyor pursuant to section 25 of the Survey Act 1986) hereby certify that this plan has been made from surveys executed by me or under my directions, that both plan and survey are correct and have been made in accordance with the Survey Regulations 1972 or any regulations made in substitution thereof.

Dated at ... this ... day
of ... 19 ... Signature ...Field Book ... p. ... Traverse Book ... p. ...
Reference Plans ... DPS19165

Examined ... Correct

Approved as to Survey

... / ... / ... Chief Surveyor

Deposited this ... day of ... 19 ...

District Land Registrar

File
Received
Instructions

96393/P

Schedule					
C.T. Allocation	Unit Description	Approx. Area (m ²)	Entitlement	Height Limits	
	UNIT 1	155		293.20	283.50
	UNIT 2	155		293.20	283.50
	UNIT 3	155		293.20	283.50
	UNIT 4	155		293.20	283.50
	FDU 5	155		293.20	283.50
	FDU 6	155		293.20	283.50
Total Unit Entitlement					

MINI-MARTY PLAN

Scheme Plan

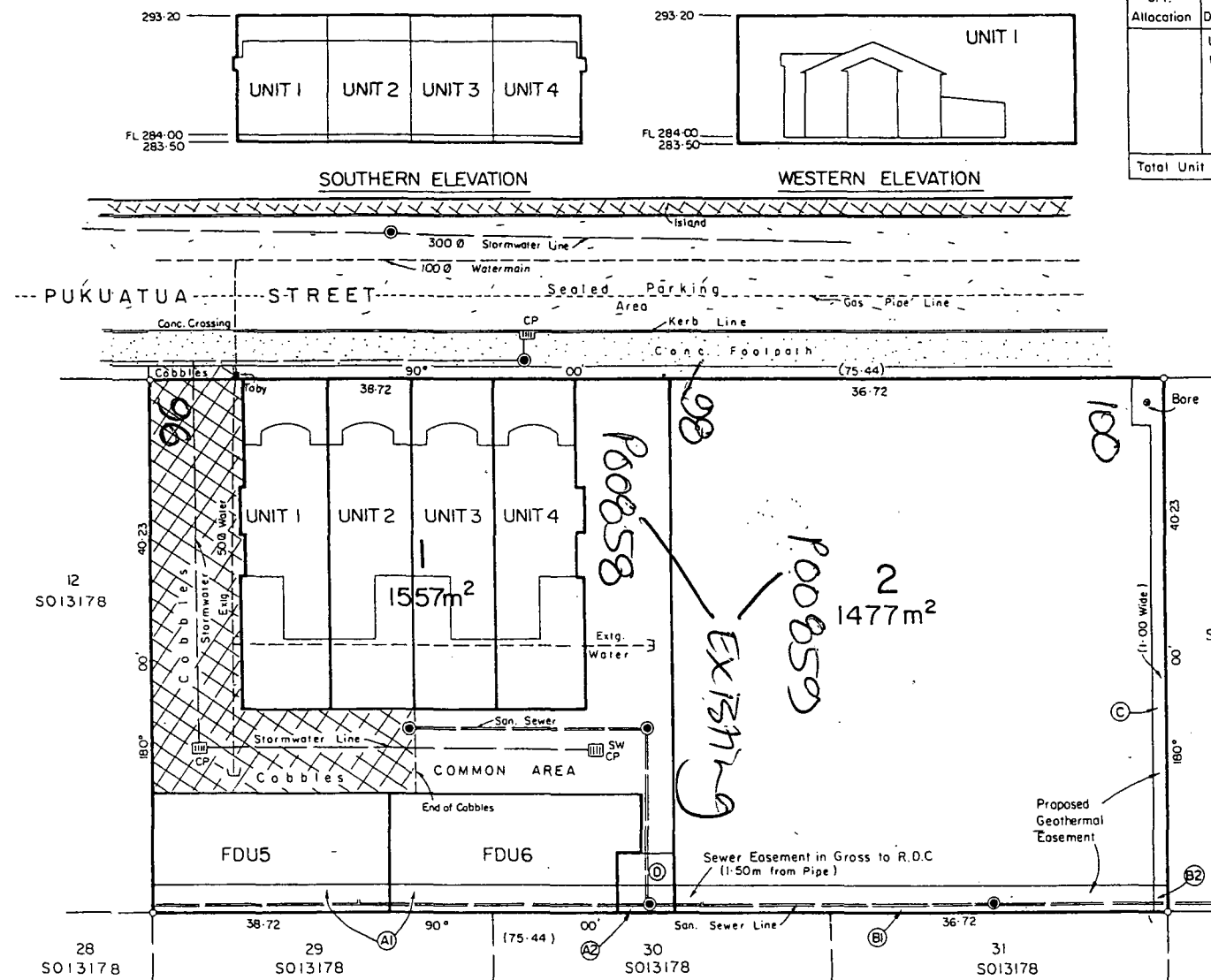
LAND DISTRICT ... SOUTH AUCKLAND
SURVEY BLK. & DIST. ... I TARAWERA
NZMS 261 SHT ... U16 RECORD MAP No ... 50:07
50:06

UNITS ON LOT 1 DPS19165 AND SUBDIVISION THEREOF

TERRITORIAL AUTHORITY ... ROTORUA DISTRICT
96393/S
Surveyed by MARTIN McCaULAY MORTON LTD.
Scale 1:250 Date JULY 1998

DATE: 7/7/98	
TO: Records -	ATTENTION: Marama
SUBDIVISION PARCEL	
Subdivision Application No:	6508108
Parent Assessment No:	6500/729 & 6500/731
FROM: Jane/Planning Administration	P00858 P00859